

Sheet No.	1
Project No.	1000
Scale	1" = 100'
Date	11/21/2013
Drawn by	JW/MS
Checked by	JW/MS
Project Name	THE HAMPTONS
Location	NORTH CAROLINA

THE HAMPTONS
NORTH CAROLINA

PRELIMINARY SKETCH DESIGN

WITHERS & RAVENEL
ENGINEERS, PLANNERS & SURVEYORS

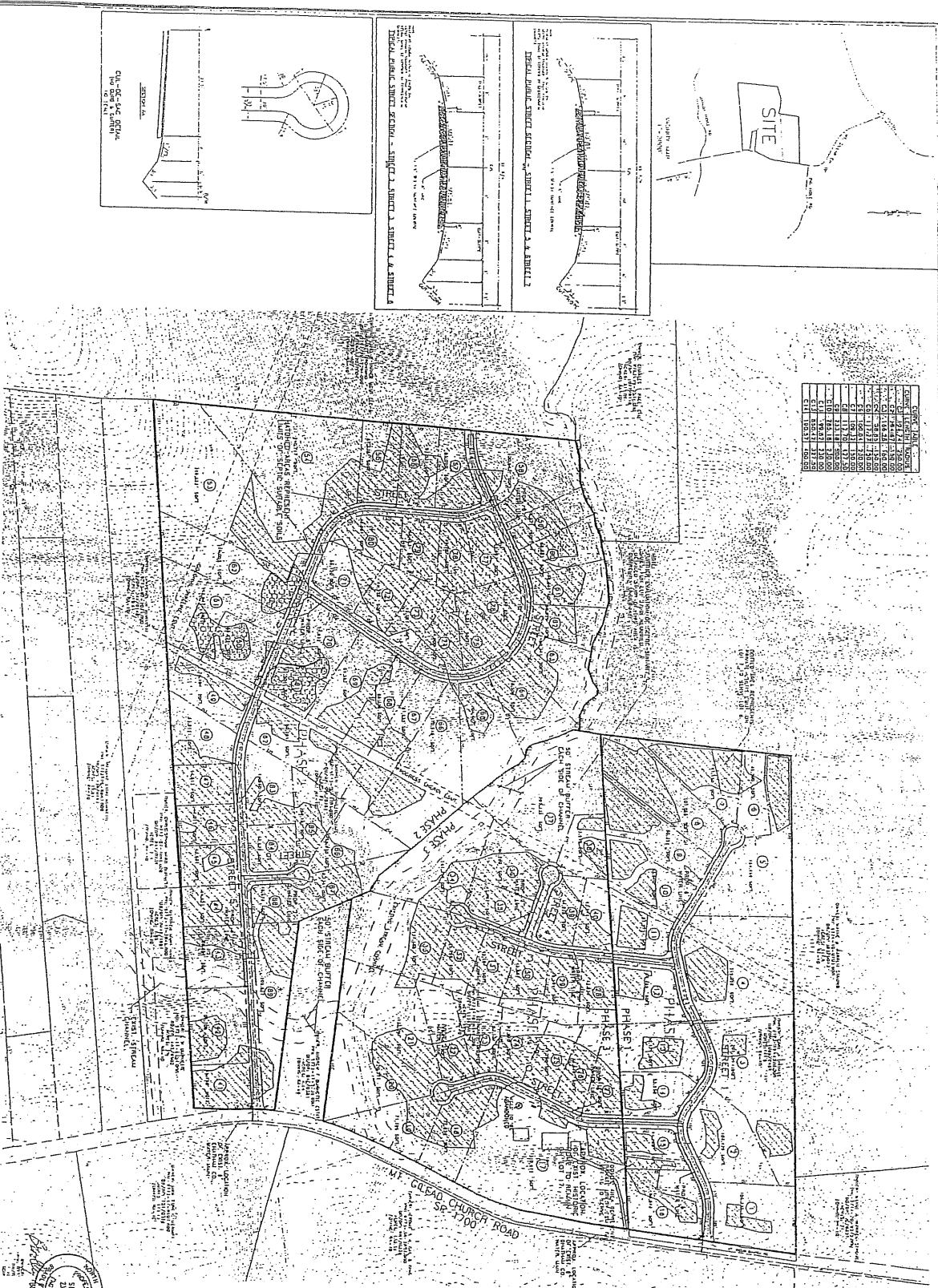

LOT NO.	ACRES	SQ. FT.
1	0.10	6,900
2	0.10	6,900
3	0.10	6,900
4	0.10	6,900
5	0.10	6,900
6	0.10	6,900
7	0.10	6,900
8	0.10	6,900
9	0.10	6,900
10	0.10	6,900
11	0.10	6,900
12	0.10	6,900
13	0.10	6,900
14	0.10	6,900
15	0.10	6,900
16	0.10	6,900
17	0.10	6,900
18	0.10	6,900
19	0.10	6,900
20	0.10	6,900
21	0.10	6,900
22	0.10	6,900
23	0.10	6,900
24	0.10	6,900
25	0.10	6,900
26	0.10	6,900
27	0.10	6,900
28	0.10	6,900
29	0.10	6,900
30	0.10	6,900
31	0.10	6,900
32	0.10	6,900
33	0.10	6,900
34	0.10	6,900
35	0.10	6,900
36	0.10	6,900
37	0.10	6,900
38	0.10	6,900
39	0.10	6,900
40	0.10	6,900
41	0.10	6,900
42	0.10	6,900
43	0.10	6,900
44	0.10	6,900
45	0.10	6,900
46	0.10	6,900
47	0.10	6,900
48	0.10	6,900
49	0.10	6,900
50	0.10	6,900
51	0.10	6,900
52	0.10	6,900
53	0.10	6,900
54	0.10	6,900
55	0.10	6,900
56	0.10	6,900
57	0.10	6,900
58	0.10	6,900
59	0.10	6,900
60	0.10	6,900
61	0.10	6,900
62	0.10	6,900
63	0.10	6,900
64	0.10	6,900
65	0.10	6,900
66	0.10	6,900
67	0.10	6,900
68	0.10	6,900
69	0.10	6,900
70	0.10	6,900
71	0.10	6,900
72	0.10	6,900
73	0.10	6,900
74	0.10	6,900
75	0.10	6,900
76	0.10	6,900
77	0.10	6,900
78	0.10	6,900
79	0.10	6,900
80	0.10	6,900
81	0.10	6,900
82	0.10	6,900
83	0.10	6,900
84	0.10	6,900
85	0.10	6,900
86	0.10	6,900
87	0.10	6,900
88	0.10	6,900
89	0.10	6,900
90	0.10	6,900
91	0.10	6,900
92	0.10	6,900
93	0.10	6,900
94	0.10	6,900
95	0.10	6,900
96	0.10	6,900
97	0.10	6,900
98	0.10	6,900
99	0.10	6,900
100	0.10	6,900

- NOTICE:
1. SETBACK PROPERTY BOUNDARIES SHOWN ARE FROM GRANITE COUNTY GIS INFORMATION.
 2. EXISTING & WATER UTILITIES SHOWN AS FROM GRANITE COUNTY GIS INFORMATION.
 3. EXISTING TOPOGRAPHY AND STREETS LOCATIONS ARE BASED ON LOCAL DATA COLLECTION RECORDS.
 4. IF ANY CONFLICTS BETWEEN THIS SKETCH DESIGN AND ANY RECORDS OR DATA ARE FOUND, THE GRANITE COUNTY RECORDS AND DATA SHALL BE DEEMED AS PRECEDENT.
 5. ALL PROPOSED STREETS ARE TO BE CONSTRUCTED IN ACCORDANCE WITH NORTH CAROLINA COUNTY REGULATIONS AND SHALL BE DESIGNED AS PUBLIC.
 6. THE GRANITE COUNTY RECORDS AND DATA SHALL BE DEEMED AS PRECEDENT FOR ALL UTILITIES AND PUBLIC UTILITIES.
 7. SETBACK PROPERTY BOUNDARIES SHOWN ARE FROM GRANITE COUNTY GIS INFORMATION.
 8. EXISTING & WATER UTILITIES SHOWN AS FROM GRANITE COUNTY GIS INFORMATION.
 9. EXISTING TOPOGRAPHY AND STREETS LOCATIONS ARE BASED ON LOCAL DATA COLLECTION RECORDS.
 10. IF ANY CONFLICTS BETWEEN THIS SKETCH DESIGN AND ANY RECORDS OR DATA ARE FOUND, THE GRANITE COUNTY RECORDS AND DATA SHALL BE DEEMED AS PRECEDENT.

ENGINEERING CONSULTANT:
WITHERS & RAVENEL, INC.
1000 W. MAIN STREET
COLUMBIANA, NC 27828
PH: 919-453-2100
FAX: 919-233-2220
E-MAIL: wwithers@witherandravel.com

ESTIMATED PROJECT DEVELOPMENT SCHEDULE:
DESIGN: JANUARY 2013 - FEBRUARY 2013
CONSTRUCTION: MARCH 2013 - AUGUST 2013
TOTAL PROJECT: JANUARY 2013 - AUGUST 2013

DEVELOPER / HOME LAND OWNER:
ALICE CALDWELL BASS, PRESIDENT
1000 W. MAIN STREET
COLUMBIANA, NC 27828
PH: 919-233-2220
FAX: 919-233-2220
E-MAIL: cbass@witherandravel.com

CONTRACTOR / HOME LAND OWNER:
ALICE CALDWELL BASS, PRESIDENT
1000 W. MAIN STREET
COLUMBIANA, NC 27828
PH: 919-233-2220
FAX: 919-233-2220
E-MAIL: cbass@witherandravel.com

PHASE 1: 10 LOTS, 0.10 ACRES
PHASE 2: 10 LOTS, 0.10 ACRES
PHASE 3: 10 LOTS, 0.10 ACRES
PHASE 4: 10 LOTS, 0.10 ACRES
PHASE 5: 10 LOTS, 0.10 ACRES
PHASE 6: 10 LOTS, 0.10 ACRES
PHASE 7: 10 LOTS, 0.10 ACRES
PHASE 8: 10 LOTS, 0.10 ACRES
PHASE 9: 10 LOTS, 0.10 ACRES
PHASE 10: 10 LOTS, 0.10 ACRES

THE HAMPTONS - PROJECT DATA

TOTAL PROJECT SITE	100.0 AC
ROAD	0.0 AC
WATERBODIES	0.0 AC
PHASE 1 / PARCEL #1	10.0 AC
PHASE 2 / PARCEL #2	10.0 AC
PHASE 3 / PARCEL #3	10.0 AC
PHASE 4 / PARCEL #4	10.0 AC
PHASE 5 / PARCEL #5	10.0 AC
PHASE 6 / PARCEL #6	10.0 AC
PHASE 7 / PARCEL #7	10.0 AC
PHASE 8 / PARCEL #8	10.0 AC
PHASE 9 / PARCEL #9	10.0 AC
PHASE 10 / PARCEL #10	10.0 AC
TOTAL PHASES	100.0 AC

